

# PHASE PROTECTION RELAYS

## 4 Functions

PPR-24F

**VTEKE**<sup>®</sup>

www.vteke.com.tr

TECHNICAL SPECIFICATIONS

| PARAMETER             | VALUE                                                    |
|-----------------------|----------------------------------------------------------|
| Operating Voltage     | 3 X 380V AC                                              |
| Operating Frequency   | 50 / 60 Hz                                               |
| Operating Power       | <4VA                                                     |
| Operating Temperature | -20°C.....55°C                                           |
| Weight                | <110Gr                                                   |
| Connection            | 3-Phase without N                                        |
| Protection Functions  | Phase Protection<br>Over/Under Voltage<br>Phase Sequence |
| Asymmetry             | %11 - Fixed                                              |
| Over Voltage          | 500VAC - Fixed                                           |
| Under Voltage         | 180VAC - Fixed                                           |
| Display               | 4 LEDS                                                   |
| Contact               | 1NO+1NC; 5A/250VAC                                       |
| Protection Class      | IP20                                                     |
| Connection Type       | Terminal Connection                                      |
| Cable Diameter        | Max2.5mm <sup>2</sup>                                    |
| Mounting              | DIN Rail Mounting                                        |
| Working Altitude      | <2000 meter                                              |

PHOTO



DIMENSIONS

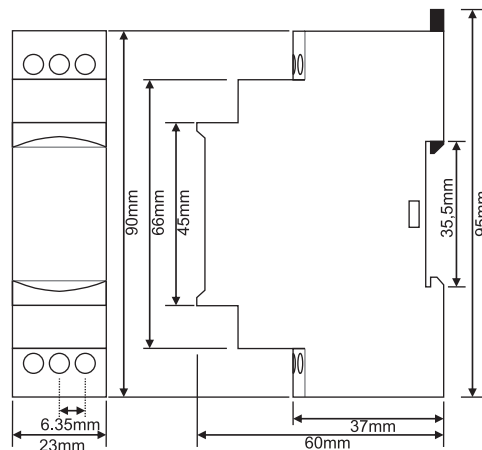

CONNECTION DIAGRAM

