



MN3PUM9



PHE111



PTM111



A14B4K11



A54B1S11

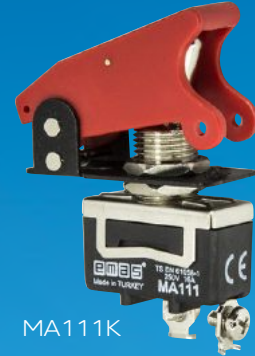

MA111K



MN1MUM8

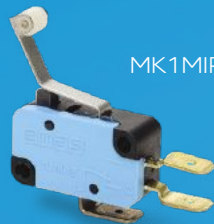

MK1MIP3



A71B1Y11



BS1012



MN2MIM2



MN2KIM2

Basic Switches

MN Series Mini Switch



MN1KIM1

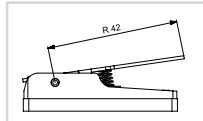

MN+KIM1



MN2KIM2

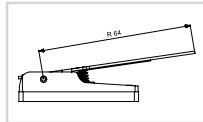

MN+KIM2



MN1KIM3

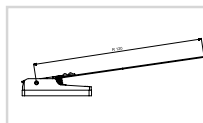

MN+KIM3



MN2MIM1

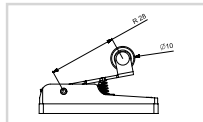

MN+MIM1



MN1MIM1A

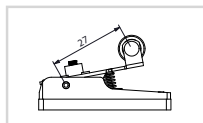

MN+MIM1A



MN2MIM1Y

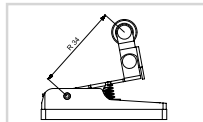

MN+MIM1Y



MN1MIM2

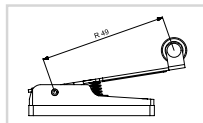

MN+MIM2



MN2MUM3

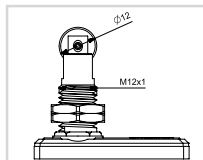

MN+MUM3



MN2MUM8

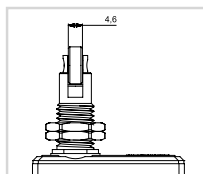

MN+MUM8



MN1MUM9

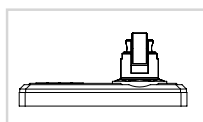

MN+MUM9

| | | | | |
|--------------|---------|---------|----------------|-----------|
| | | | | |
| | MN1 | MN2 | MN3 (IP65) | MN4 |
| Box/Pcs | 10 | 10 | 10 | 10 |
| Code | MN1KIM1 | MN2KIM1 | MN3KIM1 (IP65) | MN4KIM1 |
| Contact Type | 1 CO | 1 CO | 1 CO | 1 NC+1 NO |

| | | | | |
|--------------|---------|---------|----------------|-----------|
| Code | MN1KIM2 | MN2KIM2 | MN3KIM2 (IP65) | MN4KIM2 |
| Contact Type | 1 CO | 1 CO | 1 CO | 1 NC+1 NO |

| | | | | |
|--------------|---------|---------|----------------|-----------|
| Code | MN1KIM3 | MN2KIM3 | MN3KIM3 (IP65) | MN4KIM3 |
| Contact Type | 1 CO | 1 CO | 1 CO | 1 NC+1 NO |

| | | | | |
|--------------|---------|---------|----------------|-----------|
| Code | MN1MIM1 | MN2MIM1 | MN3MIM1 (IP65) | MN4MIM1 |
| Contact Type | 1 CO | 1 CO | 1 CO | 1 NC+1 NO |

| | | | | |
|--------------|----------|----------|-----------------|--|
| Code | MN1MIM1A | MN2MIM1A | MN3MIM1A (IP65) | |
| Contact Type | 1 CO | 1 CO | 1 CO | |

| | | | | |
|--------------|----------|----------|-----------------|-----------|
| Code | MN1MIM1Y | MN2MIM1Y | MN3MIM1Y (IP65) | MN4MIM1Y |
| Contact Type | 1 CO | 1 CO | 1 CO | 1 NC+1 NO |

| | | | | |
|--------------|---------|---------|----------------|-----------|
| Code | MN1MIM2 | MN2MIM2 | MN3MIM2 (IP65) | MN4MIM2 |
| Contact Type | 1 CO | 1 CO | 1 CO | 1 NC+1 NO |

| | | | | |
|--------------|---------|---------|----------------|--|
| Code | MN1MUM3 | MN2MUM3 | MN3MUM3 (IP65) | |
| Contact Type | 1 CO | 1 CO | 1 CO | |

| | | | | |
|--------------|---------|---------|----------------|--|
| Code | MN1MUM8 | MN2MUM8 | MN3MUM8 (IP65) | |
| Contact Type | 1 CO | 1 CO | 1 CO | |

| | | | | |
|--------------|---------|--|--|--|
| Code | MN1MUM9 | | | |
| Contact Type | 1 CO | | | |

MN Series Mini Switch

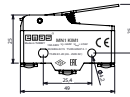

MN1

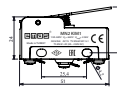

MN2

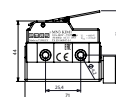

MN3 (IP65)

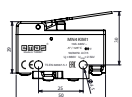

MN4



MN1PUM1

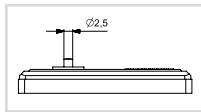

MN+PUM1



MN4PUP1

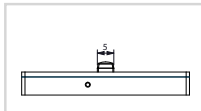

MN+PUP1



MN2PUM3

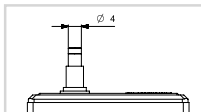

MN+PUM3



MN3PUM7

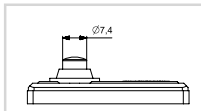

MN+PUM7



MN3PUM9

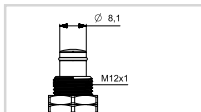

MN+PUM9

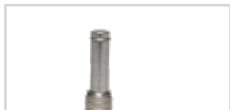

MN1PUM9U

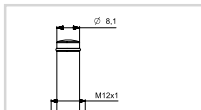

MN+PUM9U



MN2TIP11

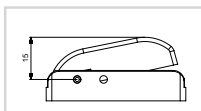

MN+TIP11



MN2TIP11Y

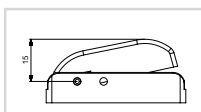

MN+TIP11Y*



MN2TIP1

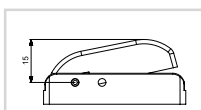

MN+TIP1

| | | | | |
|--------------|---------|---------|----------------|----|
| Box/Pcs | 10 | 10 | 10 | 10 |
| Code | MN1PUM1 | MN2PUM1 | MN3PUM1 (IP65) | |
| Contact Type | 1 CO | 1 CO | 1 CO | |

| | | | | |
|--------------|--|--|--|-----------|
| Code | | | | MN4PUP1 |
| Contact Type | | | | 1 NC+1 NO |

| | | | | |
|--------------|---------|---------|----------------|--|
| Code | MN1PUM3 | MN2PUM3 | MN3PUM3 (IP65) | |
| Contact Type | 1 CO | 1 CO | 1 CO | |

| | | | | |
|--------------|---------|---------|----------------|--|
| Code | MN1PUM7 | MN2PUM7 | MN3PUM7 (IP65) | |
| Contact Type | 1 CO | 1 CO | 1 CO | |

| | | | | |
|--------------|---------|---------|----------------|--|
| Code | MN1PUM9 | MN2PUM9 | MN3PUM9 (IP65) | |
| Contact Type | 1 CO | 1 CO | 1 CO | |

| | | | | |
|--------------|----------|--|--|--|
| Code | MN1PUM9U | | | |
| Contact Type | 1 CO | | | |

| | | | | |
|--------------|--|----------|--|--|
| Code | | MN2TIP11 | | |
| Contact Type | | 1 NO | | |

| | | | | |
|--------------|--|------------|--|--|
| Code | | MN2TIP11Y* | | |
| Contact Type | | 1 NO | | |

| | | | | |
|--------------|--|---------|--|--|
| Code | | MN2TIP1 | | |
| Contact Type | | 1 CO | | |

| Code | Type | Features | Box/Pcs |
|---------|------------------|--------------------------|---------|
| MN1YKAP | Protection Cover | Suitable for MN1 and MN2 | 10 |

* Hardened spring and green button



MK1PUP1



MK1KIM1



MK1MIP3



MK1KIM5



MK1PUM9



MK1KIM31A



MK1KIM2



MK1KIM3

Micro Switch

| Code | Contact Type | Actuator | Actuator Material | Box/Pcs |
|-----------|--------------|--------------|-------------------|---------|
| MK1PUM9 | 1 CO | Plunger | Metal | 10 |
| MK1PUP1 | 1 CO | Plunger | Plastic | 50 |
| MK1PUP1Y | 1 CO | Plunger | Soft Plastic | 50 |
| MK1KIM1 | 1 CO | Lever | Metal | 50 |
| MK1KIM2 | 1 CO | Lever | Metal | 50 |
| MK1KIM3 | 1 CO | Lever | Metal | 50 |
| MK1KIM31A | 1 NC | Lever | Metal | 50 |
| MK1KIM4 | 1 CO | Lever | Metal | 50 |
| MK1KIM5 | 1 CO | Lever | Metal | 40 |
| MK1MIM1 | 1 CO | Roller Lever | Metal | 40 |
| MK1MIM2 | 1 CO | Roller Lever | Metal | 40 |
| MK1MIP1 | 1 CO | Roller Lever | Metal | 50 |
| MK1MIP2 | 1 CO | Roller Lever | Plastic | 40 |
| MK1MIP3 | 1 CO | Roller Lever | Plastic | 40 |



MK1KIM4



MK1MIM1



MK1MIM2



MK1MIP1



MK1MIP2



BS1022



BS1012



BS1010E



BS1012E



BS1011V

Button Switch, IP50

| Code | Contact Type | Actuator | Actuator Material | Box/Pcs |
|---------|----------------------|--------------------|----------------------------|---------|
| BS1010 | 1 NO, Snap Action | Plunger | Plastic | 20 |
| BS1010E | 1 NO, Snap Action | Plunger | Plastic with Silicon Cover | 16 |
| BS1011 | 1 NC, Snap Action | Plunger | Plastic | 20 |
| BS1011E | 1 NC, Snap Action | Plunger | Plastic with Silicon Cover | 16 |
| BS1011V | 1NO, Snap Action | Plunger (17,20 mm) | Plastic | 20 |
| BS1012 | 1NO+1NC, Snap Action | Plunger | Plastic | 20 |
| BS1012E | 1NO+1NC, Snap Action | Plunger | Plastic with Silicon Cover | 16 |
| BS1020 | 1 NO, Slow Action | Plunger | Plastic | 20 |
| BS1021 | 1 NC, Slow Action | Plunger | Plastic | 20 |
| BS1022 | 1NO+1NC, Snap Action | Plunger | Plastic | 20 |
| BS1040 | 1 NO, Snap Action | Plunger | Plastic | 20 |
| BS1041 | 1 NC, Snap Action | Plunger | Plastic | 20 |
| BS1042 | 1NO+1NC, Snap Action | Plunger | Plastic | 20 |



BS1010TX1

Button Switches, IP 67

| Code | Contact Type | Cable Length | Actuator | Actuator Material | Box/Pcs |
|-----------|-----------------------------|--------------|----------|---------------------------|---------|
| BS1010TX1 | 1NO, Snap Action | 1m | Plunger | Plastic, With Silicon Cap | 1 |
| BS1011TX1 | 1NC, Snap Action | 1m | Plunger | Plastic, With Silicon Cap | 1 |
| BS1012TX1 | Double Circuit, Snap Action | 1m | Plunger | Plastic, With Silicon Cap | 1 |



MA111



MA211



MA111K



MAK

Toggle Switch

| Code | Contact Type | Cable Connection | Actuator Material | Plate | Box/Pcs |
|---------|--------------|-----------------------|------------------------|----------------|---------|
| MA111 | 1 NO | 2 Screws | Metal | On-Off | 10 |
| MA111K | 1 NO | 2 Screws, With cover | Metal | On-Off | 10 |
| MA111L | 1 NO | 2 Soldering Terminals | Metal | On-Off | 10 |
| MA111T | 1 NO | 2 Terminals | Metal | On-Off | 10 |
| MA111TT | 1 NO | 2 Terminals | Metal | On-Off (Black) | 10 |
| MA112 | 1 NO, 1 NC | 3 Screws | Metal | On-On | 10 |
| MA113 | 1 NO, 1 NO | 3 Screws | Metal | On-Off-On | 10 |
| MA121 | 1 NO | 2 Screws | Metal, Plastic Covered | On-Off | 10 |
| MA122 | 1 NO, 1 NC | 3 Screws | Metal, Plastic Covered | On-On | 10 |
| MA123 | 1 NO, 1 NO | 3 Screws | Metal, Plastic Covered | On-Off-On | 10 |
| MA211 | 2 NO | 4 Screws | Metal | On-Off | 6 |
| MA212 | 2 NO + 2 NC | 6 Screws | Metal | On-On | 6 |
| MA212T | 2 NO + 2 NC | 6 Terminals | Metal | On-On | 6 |
| MA213 | 2 NO + 2 NO | 6 Screws | Metal | On-Off-On | 6 |
| MA213T | 2 NO + 2 NO | 6 Terminals | Metal | On-Off-On | 6 |
| MA221 | 2 NO | 4 Screws | Metal, Plastic Covered | On-Off | 6 |
| MA222 | 2 NO + 2 NC | 6 Screws | Metal, Plastic Covered | On-On | 6 |
| MA222T | 2 NO + 2 NC | 6 Terminals | Metal, Plastic Covered | On-On | 6 |
| MA223 | 2 NO + 2 NO | 6 Screws | Metal, Plastic Covered | On-Off-On | 6 |
| MA223T | 2 NO + 2 NC | 6 Terminals | Metal, Plastic Covered | On-Off-On | 6 |
| MAK | - | - | Plastic | - | 10 |



MAY111



MAY211



MAY213



MAY222

Toggle Switch, Spring Return

| Code | Contact Type | Cable Connection | Actuator Material | Plate | Box/Pcs |
|---------|--------------|-----------------------|------------------------|-----------|---------|
| MAY111 | 1 NO | 2 Screws | Metal | On-Off | 10 |
| MAY111L | 1 NO | 2 Soldering Terminals | Metal | On-Off | 10 |
| MAY111T | 1 NO | 2 Terminals | Metal | On-Off | 10 |
| MAY112 | 1 NO, 1 NO | 3 Screws | Metal | On-On | 10 |
| MAY113 | 1 NO, 1 NO | 3 Screws | Metal | On-Off-On | 10 |
| MAY121 | 1 NO | 2 Screws | Metal, Plastic Covered | On-Off | 10 |
| MAY122 | 1 NO, 1 NO | 3 Screws | Metal, Plastic Covered | On-On | 10 |
| MAY123 | 1 NO, 1 NO | 3 Screws | Metal, Plastic Covered | On-Off-On | 10 |
| MAY211 | 2 NO | 4 Screws | Metal | On-Off | 6 |
| MAY212 | 2 NO + 2 NO | 6 Screws | Metal | On-On | 6 |
| MAY212T | 2 NO + 2 NO | 6 Terminals | Metal | On-On | 6 |
| MAY213 | 2 NO + 2 NO | 6 Screws | Metal | On-Off-On | 6 |
| MAY213T | 2 NO + 2 NO | 6 Terminals | Metal | On-Off-On | 6 |
| MAY221 | 2 NO | 4 Screws | Metal, Plastic Covered | On-Off | 6 |
| MAY222 | 2 NO + 2 NO | 6 Screws | Metal, Plastic Covered | On-On | 6 |
| MAY222T | 2 NO + 2 NO | 6 Terminals | Metal, Plastic Covered | On-On | 6 |
| MAY223 | 2 NO + 2 NO | 6 Screws | Metal, Plastic Covered | On-Off-On | 6 |



K25001T



K25011V

Medium Voltage Cell Switches

| Code | Contact Type | Terminal Type | Box/Pcs |
|---------|--------------|---------------|---------|
| K25001T | 2 NC, 1 NO | 6 Terminals | 10 |
| K25001V | 2 NC, 1 NO | 6 Screws | 10 |
| K25011T | 1 NC, 2 NO | 6 Terminals | 10 |
| K25011V | 1 NC, 2 NO | 6 Screws | 10 |



A12B1H10



A12B1K11



A12B1S11



A12B1Y11 (3)



A12W1K11



A14B1K11



A21B1H10



A21B1S11



A21B1K11



A54B1H10



A54B1Y11



A71B1K11



A71B1Y11



A71B1S11



EK1



EK2



PTM110



PTM111



PHE110



PTM122

Illuminated Rocker Switch

| Code | Housing Type | Housing Colour | Feature | Contact Type | Plate | Button Colour | Cable Connection | Box/Pcs |
|-----------|--------------|----------------|----------------------|--------------|-------|---------------|----------------------------|---------|
| A12B1H10 | 30*22mm | Black | WO/Illumination | 1NO + 1NO | 0-1 | H | Terminal | 50 |
| A12B1K11 | 30*22mm | Black | W/Illumination | 1NO + 1NO | 0-1 | K | Terminal | 50 |
| A12B1S11 | 30*22mm | Black | W/Illumination | 1NO + 1NO | 0-1 | S | Terminal | 50 |
| A12B1Y11 | 30*22mm | Black | W/Illumination | 1NO + 1NO | 0-1 | Y | Terminal | 50 |
| A12B5H10 | 30*22mm | Black | WO/Illumination | 1NO + 1NO | 0-1 | H | Bridge | 50 |
| A12B5K11 | 30*22mm | Black | W/Illumination | 1NO + 1NO | 0-1 | K | Bridge | 50 |
| A12B5S11 | 30*22mm | Black | W/Illumination | 1NO + 1NO | 0-1 | S | Bridge | 50 |
| A12B5Y11 | 30*22mm | Black | W/Illumination | 1NO + 1NO | 0-1 | Y | Bridge | 50 |
| A12W1H10 | 30*22mm | White | WO/Illumination | 1NO + 1NO | 0-1 | H | Terminal | 50 |
| A12W1K11 | 30*22mm | White | W/Illumination | 1NO + 1NO | 0-1 | K | Terminal | 50 |
| A12W1S11 | 30*22mm | White | W/Illumination | 1NO + 1NO | 0-1 | S | Terminal | 50 |
| A12W1Y11 | 30*22mm | White | W/Illumination | 1NO + 1NO | 0-1 | Y | Terminal | 50 |
| A14B1H10 | 30*22mm | Black | WO/Illumination | 2NO | 0-1 | H | Terminal | 50 |
| A14B1K11 | 30*22mm | Black | W/Illumination | 2NO | 0-1 | K | Terminal | 50 |
| A14B1S11 | 30*22mm | Black | W/Illumination | 2NO | 0-1 | S | Terminal | 50 |
| A14B1Y11 | 30*22mm | Black | W/Illumination | 2NO | 0-1 | Y | Terminal | 50 |
| A14B4H10 | 30*22mm | Black | WO/Illumination | 2NO | 0-1 | H | Screw | 50 |
| A14B4K11 | 30*22mm | Black | W/Illumination | 2NO | 0-1 | K | Screw | 50 |
| A14B4S11 | 30*22mm | Black | W/Illumination | 2NO | 0-1 | S | Screw | 50 |
| A14B4Y11 | 30*22mm | Black | W/Illumination | 2NO | 0-1 | Y | Screw | 50 |
| A14B5H10 | 30*22mm | Black | WO/Illumination | 2NO | 0-1 | H | Bridge | 50 |
| A14B5K11 | 30*22mm | Black | W/Illumination | 2NO | 0-1 | K | Bridge | 50 |
| A14B5S11 | 30*22mm | Black | W/Illumination | 2NO | 0-1 | S | Bridge | 50 |
| A14B5Y11 | 30*22mm | Black | W/Illumination | 2NO | 0-1 | Y | Bridge | 50 |
| A14B6H10 | 30*22mm | Black | WO/Illumination | 2NO | 0-1 | H | Protected Screw | 50 |
| A14B6K11 | 30*22mm | Black | W/Illumination | 2NO | 0-1 | K | Protected Screw | 50 |
| A14B6S11 | 30*22mm | Black | W/Illumination | 2NO | 0-1 | S | Protected Screw | 50 |
| A14B6Y11 | 30*22mm | Black | W/Illumination | 2NO | 0-1 | Y | Protected Screw | 50 |
| A14W1K11 | 30*22mm | White | W/Illumination | 2NO | 0-1 | K | Terminal | 50 |
| A14W1S11 | 30*22mm | White | W/Illumination | 2NO | 0-1 | S | Terminal | 50 |
| A14W1Y11 | 30*22mm | White | W/Illumination | 2NO | 0-1 | Y | Terminal | 50 |
| A14W1BP1K | 30*22mm | White | W/Illumination/Lens | 2NO | 0-1 | B | Terminal | 50 |
| A21B1H10 | 30*11mm | Black | WO/Illumination | 1NO | 0-1 | H | Terminal | 50 |
| A21B1K11 | 30*11mm | Black | W/Illumination | 1NO | 0-1 | K | Terminal | 50 |
| A21B1S11 | 30*11mm | Black | W/Illumination | 1NO | 0-1 | S | Terminal | 50 |
| A21B1Y11 | 30*11mm | Black | W/Illumination | 1NO | 0-1 | Y | Terminal | 50 |
| A21W1K11 | 30*11mm | White | W/Illumination | 1NO | 0-1 | K | Terminal | 50 |
| A21W1S11 | 30*11mm | White | W/Illumination | 1NO | 0-1 | S | Terminal | 50 |
| A21W1Y11 | 30*11mm | White | W/Illumination | 1NO | 0-1 | Y | Terminal | 50 |
| A44B1HX1 | 20*13mm | Black | W/Illumination | 2NO | - | - | Terminal | 50 |
| A44B9HX1 | 20*13mm | Black | W/Illumination | 2NO | - | - | Terminal + Protected Screw | 50 |
| A54B1H10* | 30*22mm | Black | WO/Illumination IP65 | 2NO | 0-1 | H | Terminal | 50 |
| A54B1K11* | 30*22mm | Black | W/Illumination IP65 | 2NO | 0-1 | K | Terminal | 50 |
| A54B1S11* | 30*22mm | Black | W/Illumination IP65 | 2NO | 0-1 | S | Terminal | 50 |
| A54B1Y11* | 30*22mm | Black | W/Illumination IP65 | 2NO | 0-1 | Y | Terminal | 50 |
| A71B1H10 | Dia 22mm | Black | WO/Illumination | 1NO | 0-1 | H | Terminal | 50 |
| A71B1K11 | Dia 22mm | Black | W/Illumination | 1NO | 0-1 | K | Terminal | 50 |
| A71B1S11 | Dia 22mm | Black | W/Illumination | 1NO | 0-1 | - | Terminal | 50 |
| A71B1Y11 | Dia 22mm | Black | W/Illumination | 1NO | 0-1 | Y | Terminal | 50 |

* When will be written 25 instead of * it will be 25A.

| Code | Type | Box/Pcs |
|------|---------------------|---------|
| EK1 | Silicon Cover, Slim | 100 |
| EK2 | Silicon Cover, Wide | 100 |

Panel Thermostats

| Code | Operation | Feature & Type | Contact | Box/Pcs |
|---------|------------------------------------|-----------------------------------|------------------------------------|---------|
| PTM110 | Mechanical | Thermostat (Panel Type) | NC (Heating-Red) | 1 |
| PTM111 | Mechanical | Thermostat (Panel Type) | NO (Cooling-Blue) | 1 |
| PTM122 | Mechanical | Thermostat (Panel Type) | NC (Heating-Red)+NO (Cooling-Blue) | 1 |
| PTE110 | Electronic | Thermostat (Panel Type) | NC | 1 |
| PTE111 | Electronic | Thermostat (Panel Type) | NO | 1 |
| PHTE124 | Analogue (Digital Sensor Included) | Thermostat+Hygrostat (Panel Type) | 1 CO | 1 |
| PHE110 | Electronic | Hygrostat (Panel Type) | NC | 1 |
| PHE111 | Electronic | Hygrostat (Panel Type) | NO | 1 |